

Reference images

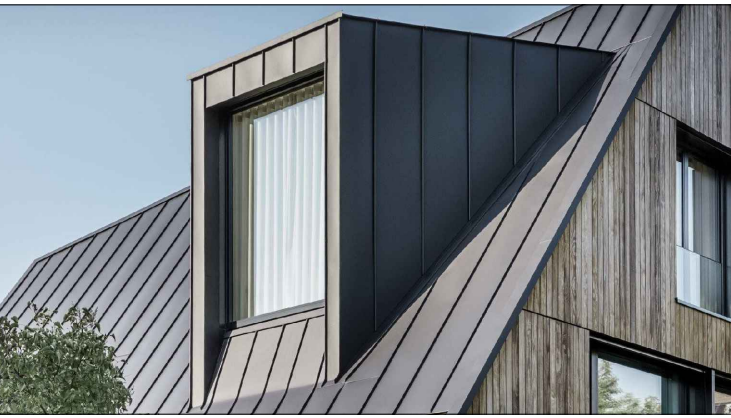

aluminum cladding
Warm Mid Grey standing seam Aluminum cladding or similar approved cladding

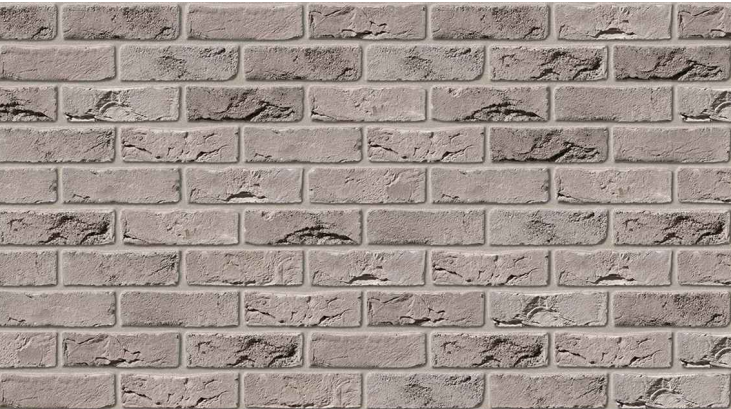

brick cladding
Warm Mid Grey Textured Brick with Light cream Mortar or similar approved



render
1. Light warm grey render or similar approved
2. Cream render or similar approved

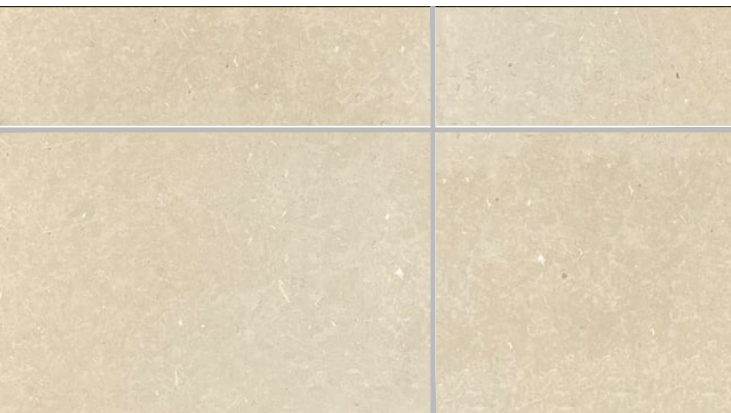

light stone cladding
Moca Cream Limestone or similar approved



aluminum cladding
aged copper standing seam aluminum cladding or similar approved cladding

Landscape
for design and details refer to CSR Landscape Drawings

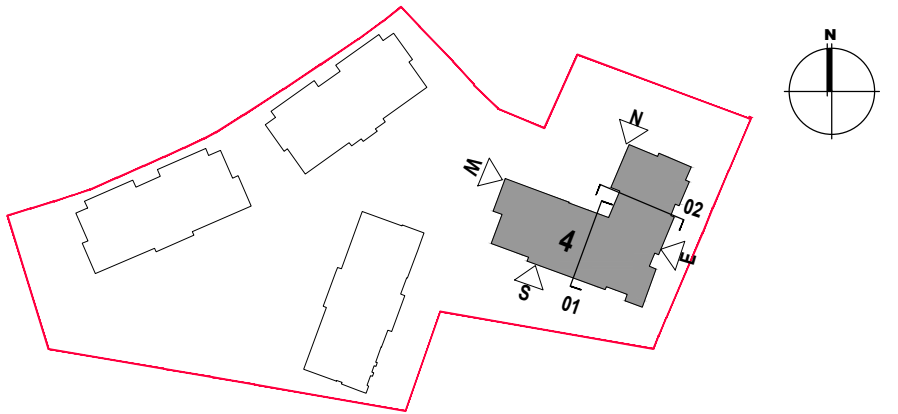

Block 4 Elevations



01 Block 4 South Elevation
1:200



02 Block 4 East Elevation
1:200



03 Block 4 North Elevation
1:200



04 Block 4 West Elevation
1:200

Notes		Issue Status		No.		Date		Revision		Initials	
1. Copyright Reserved		Progress				F		03.04.25		DK	
2. Work to figured dimensions only. Do not scale drawing.		Planning Application									
3. The contractor is responsible for checking all levels and dimensions on site and shall refer all discrepancies to the Architect		Fire Cert									
4. Where appropriate, for details of r.c. structure, or mechanical and electrical details, see Engineers drawings		Disability Cert									
5. Proprietary items shall be fixed in strict accordance with manufacturers instructions.		Tender									
6. Sizes of proprietary items shall be checked with manufacturer.		Construction									
7. The contractor shall be responsible for the coordination of structure, finishes and services.		As Built									
		Information Only									
M:\Project Section - Current\6284 Kinsale Road\CAD\Planning\Planning 1\15 LRD Planning Application\2 CAD Drawings\2 Elevations\Block 4 Elevations.dwg 04/04/2025 12:06:27											

Project		Kinsale Road LRD			
Drawing Title		Block 4 Elevations			
Stage	Planning	Scale	1:200@A1	Drawn	DK MD
Project Code	6284	job	KRC	zone	04
		origin	BKD	level	ZZ
				type	DR
				ds	A
				sheet no.	2000
				status	P3.4
				rev	F
				date	20:10:23

bkdarchitects

2ND FLOOR EUROPA HOUSE, HARCOURT CENTRE, HARCOURT ST. DUBLIN D2.
002 WR02, IRELAND - EMAIL:ARCHITECTURE@BKD.IE - PH:01 616 2400 - W: WWW.BKD.IE